



INSTALLATION INSTRUCTIONS

Accessory
CHROME SADDLEBAG RAILS
 P/N 08P52-MCA-100

Application
GL1800

Publications No.
 Issue Date
December 2000

Honda Dealer: Please give a copy of this instruction to your customer.

PARTS LIST

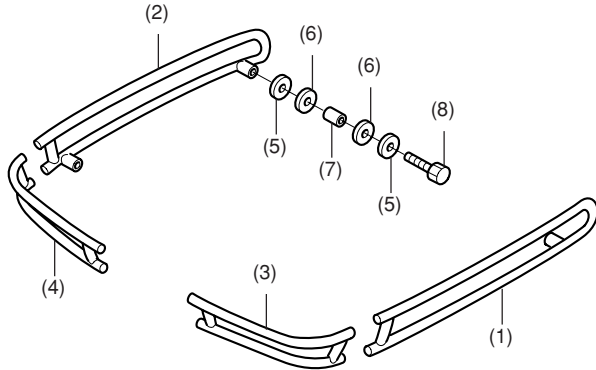

No.	Description	Q'ty
(1)	Right rail	1
(2)	Left rail	1
(3)	Right rear rail	1
(4)	Left rear rail	1
(5)	Washer	20
(6)	Rubber washer	20
(7)	Collar	10
(8)	6 mm Bolt	10

TOOLS AND SUPPLIES REQUIRED

- Socket (10 mm)
- Ratchet
- Electric drill motor
- Drill bit (3 mm, 6 mm and 9 mm)
- Wood block
- Marker
- Shop towel
- Torque wrench

TORQUE CHART

Be sure to tighten all bolts and nuts to their specified torque.

Item	N·m	kgf·m	lbf·ft
6mm Bolt	10	1.0	7

Customer Information: The information in this Accessory Installation Instruction is intended for use only by skilled technicians who have the proper tools, equipment, and training to correctly and safely add equipment to your motorcycle. These procedures should not be attempted by "do-it-yourselfers."

INSTALLATION

1. Remove the right saddlebag from the motorcycle.

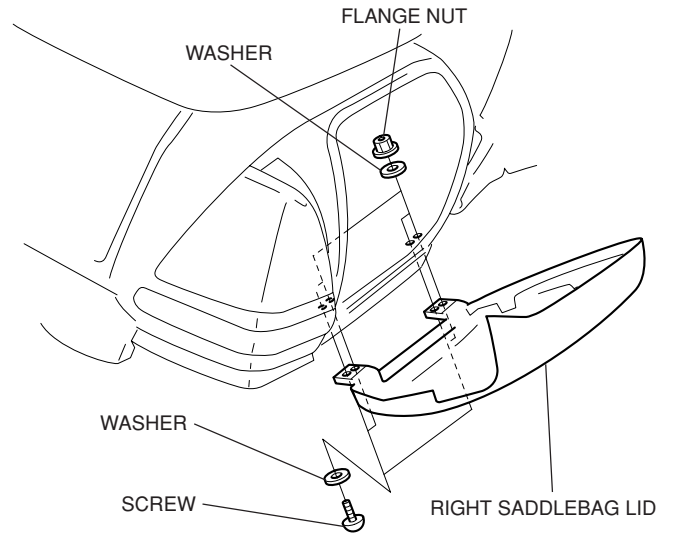

2. Remove the inner lid from the right saddlebag lid you just removed.

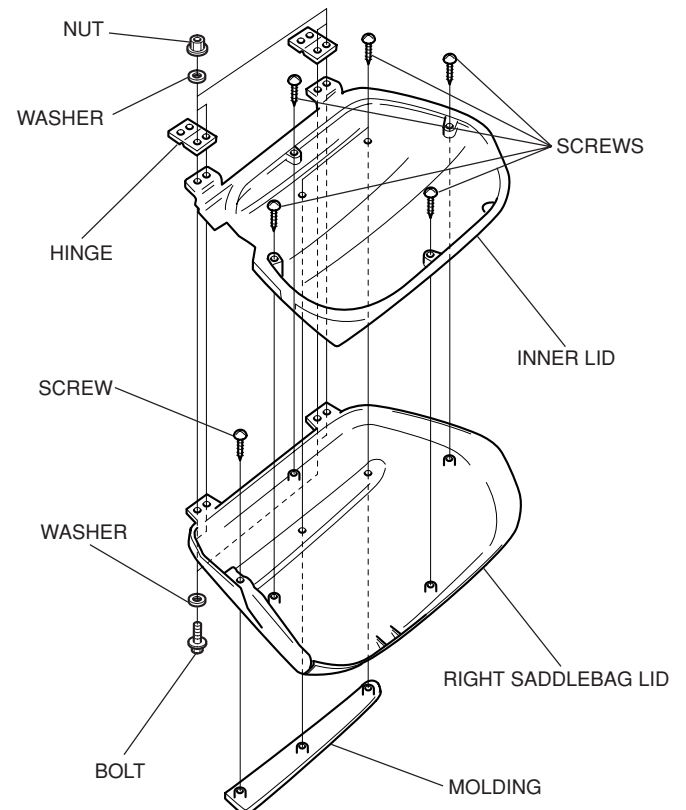

3. Inside the right saddlebag lid, locate the two marks and drill a hole through each mark using an electric drill motor starting with a 3 mm, 6 mm and finally with a 9 mm drill bit.

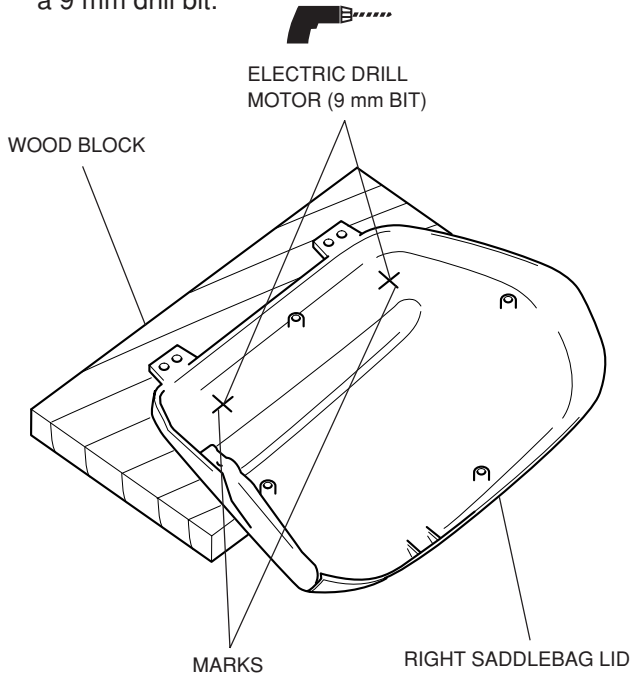

4. Install the right rail on the right saddlebag lid as shown.

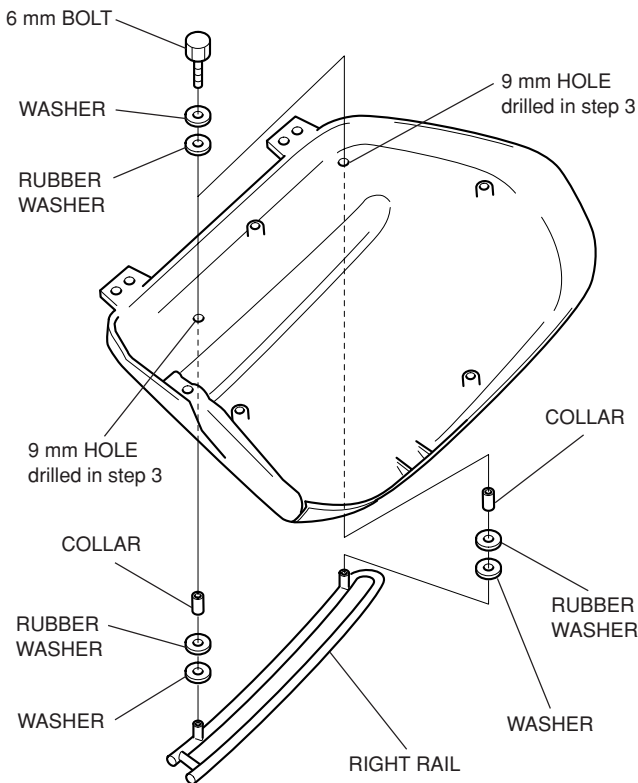

5. Reinstall the inner lid on the right saddlebag lid in the reverse order of removal.

6. Inside the right trunk body, locate the two marks and drill a hole through each mark using an electric drill motor starting with a 3 mm, 6 mm and finally with a 9 mm drill bit.

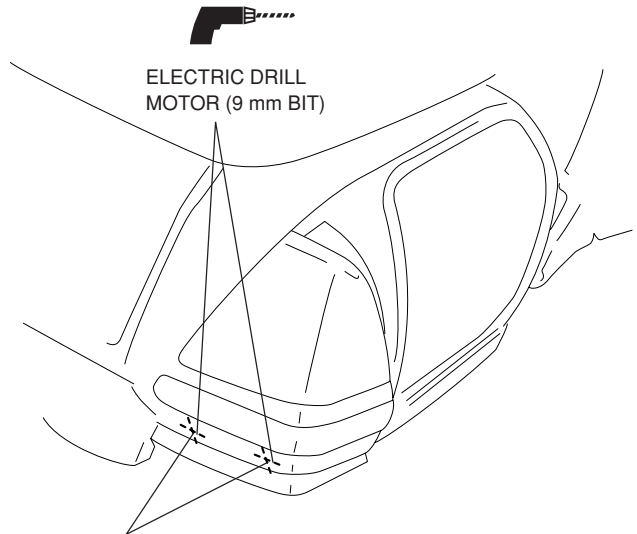

7. Temporarily install the right rear rail with the two 6 mm bolts. After marking, remove the rail and drill a hole using an electric drill starting with a 3 mm, 6 mm and finally with a 9 mm drill bit through the mark you just made.

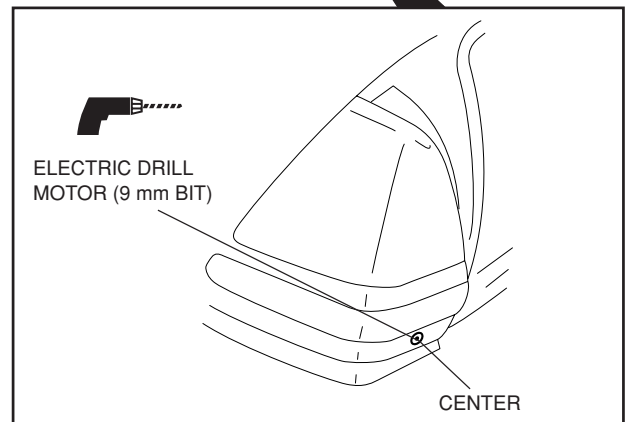
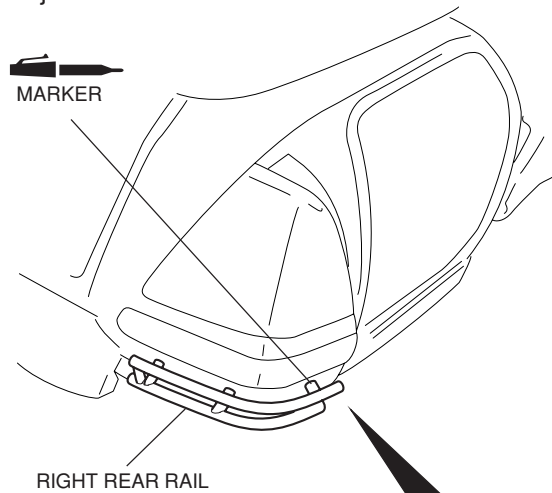

8. Install the right rear rail on the right saddlebag lid as shown.

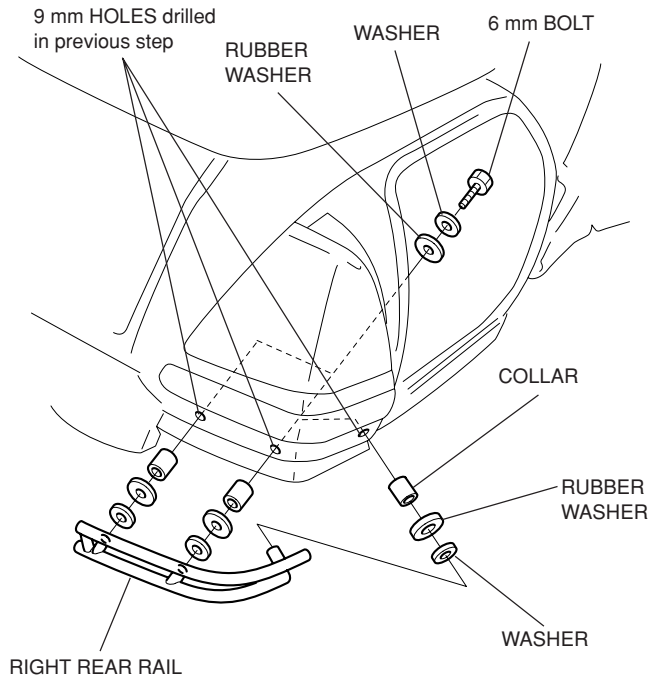

9. Reinstall the right saddlebag lid in the reverse order of removal.

10. Repeat on the left side.