

INSTALLATION INSTRUCTIONS

Accessory
CHROME REAR LOWER COWL
 P/N 08F81-MCA-100F

Application
GL1800

Publications No.
 Issue Date
October 2000

PARTS LIST

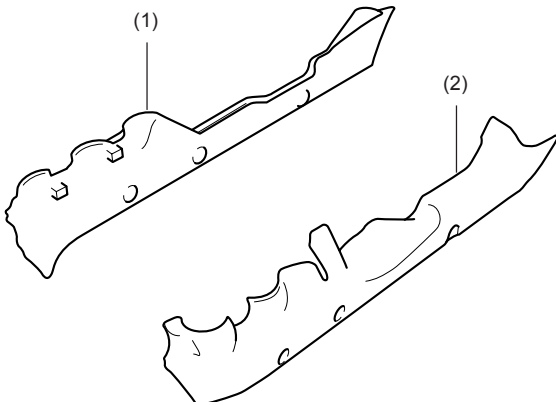

No.	Description	Q'ty
(1)	Right chrome rear lower cowl	1
(2)	Left chrome rear lower cowl	1

INSTALLATION

NOTE:

- To prevent scalding, allow the engine and cooling system to cool before installing the radiator cowl.

- Remove the front lower cowl as described in the Service Manual.

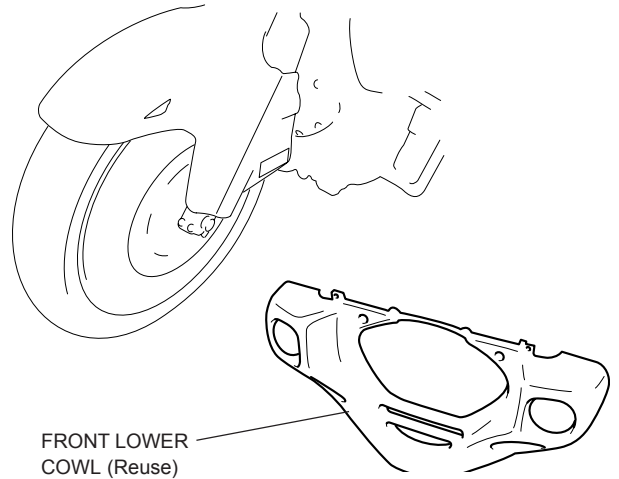

- Remove the left rear lower cowl.

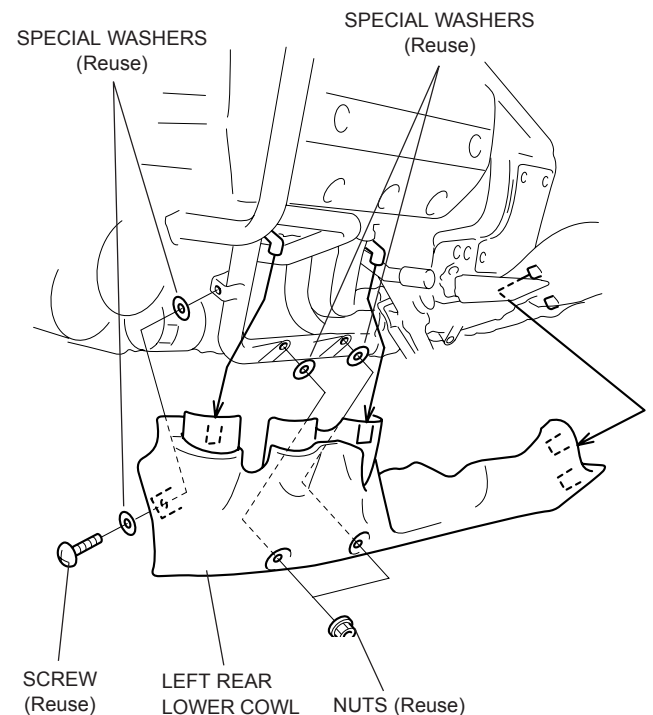

3. Remove the left inner guard and rubber from the left rear lower cowl.

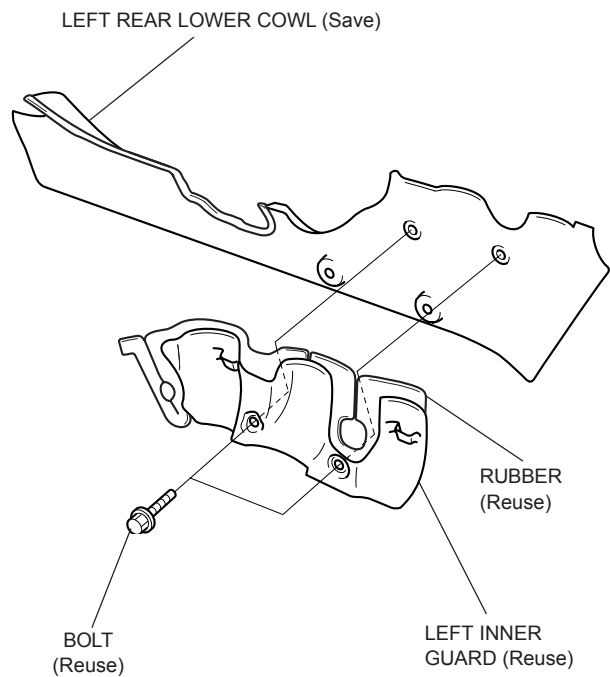

4. Reinstall the left inner guard and rubber on the left chrome rear lower cowl in the reverse order of removal.
5. Reinstall the left chrome rear lower cowl in the reverse order of removal.
6. Repeat on the right chrome rear lower cowl.

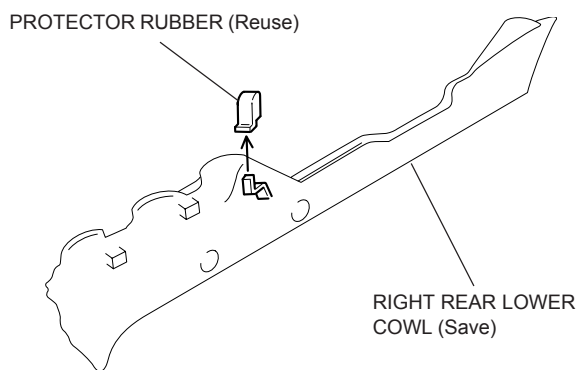

7. Reinstall the front lower cowl.